

## Adapter Mounting Plate Installation

The MOBOTIX MOVE Vandal Multisensor PTZ Combo can be mounted on the wall with the accessory: Mx-M-VMSD-AP.

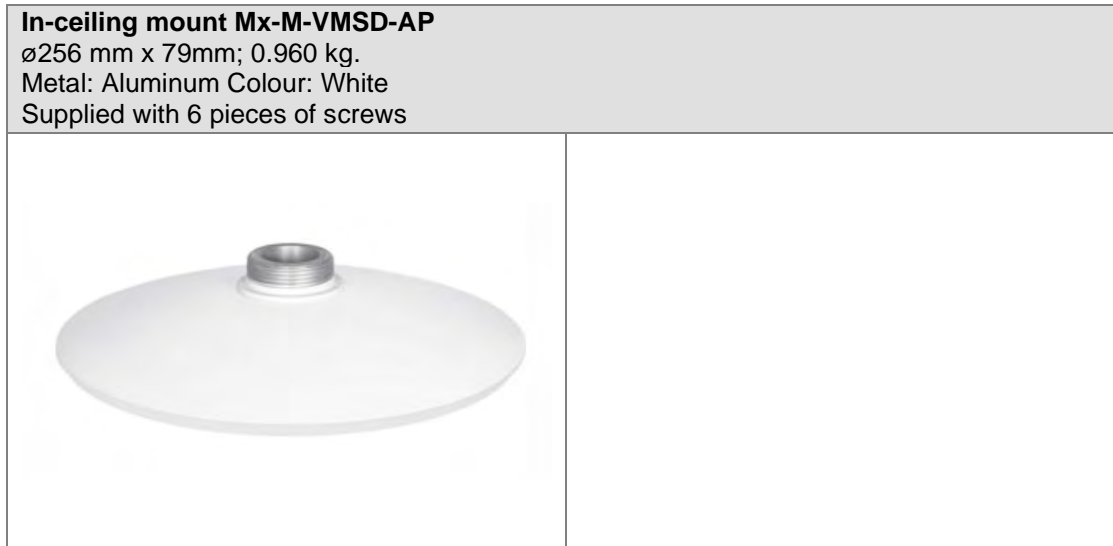

### Tools / Installation Material required:

- Sealant for waterproof treatment
- Ethernet Cable
- Safety wire
- Fixing screw for safety wire
- Hex wrench

Follow the steps below to install the camera with an In-ceiling mount.

### STEP 1

Open the mounting plate in the pendant mount. Please refer to the red frame in the figure on the right.



## STEP 2

Make a cable entry hole on the wall to recess the cables. Run the Ethernet cable through the pendant mount. If there are other cables, such as power cable, alarm I/O cable or audio I/O cable, also insert them through the pendant mount.



Please block the cable entry hole with the supplied sponge to avoid insects entering the pendant mount. The sponge can be placed in two ways as shown in the illustrations below. **Sponge**

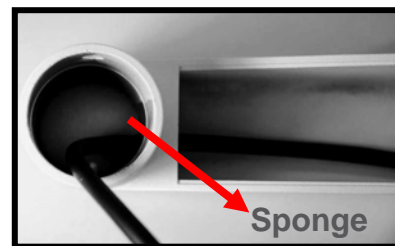
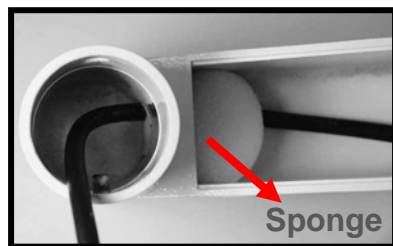

## STEP 3

Align the screw holes on the pendant mount with the drilled holes and fix the pendant mount to the wall with four screws.

## STEP 4

Then thread the Ethernet cable and other cables through the pendant cap and fix the adapter plate to the pendant mount.

## STEP 5

Remove the desiccant and use a screwdriver to loosen the connecting screws between the camera and the camera adapter plate.

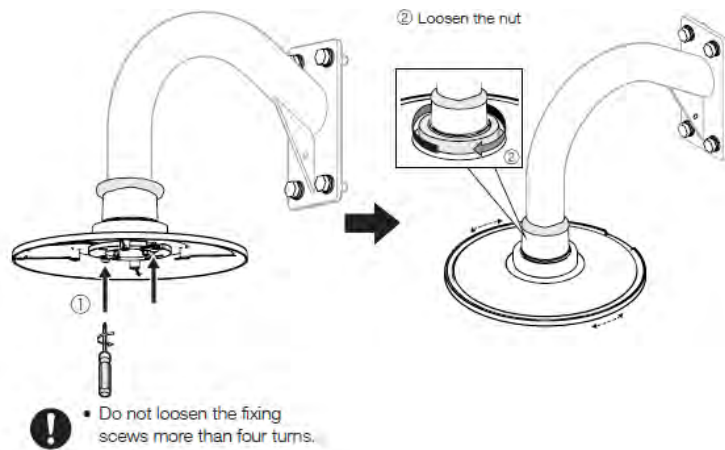

**STEP 6**

Attach the anti-drop chain from the camera to the anti-drop ring on the pendant cap. Now fix the adapter plate from the camera to pendant cap.

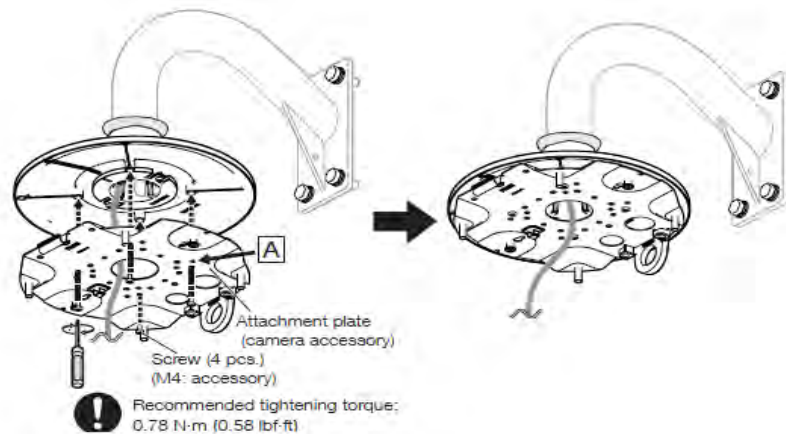

**STEP 7**

Attach the ground wire to the grounding ring and firmly secure it to the camera using an M4 screw.

**STEP 8**

Use screws to secure the camera to the Adapter Plate

**STEP 9**

Slightly pull the cables into the pendant tube. Then screw the mounting plate back to the standard/mini pendant mount.



**STEP 10**

Attach the dome cover to the camera, align the arrow mark on the dome cover with the one on the camera housing and fasten the two security screws. And the pendant cap mount installation is completed.